

BYU | MARRIOTT SCHOOL

Global Supply Chain Management 2017 Supply Chain Day and Alumni Conference Revised Schedule

Thursday, October 5, 2017 (pre-conference event)

6:30-8:30 p.m.	Global Supply Chain Achievement Recognition banquet for those who registered. (W410 TNRB)
----------------	-------------------------------------------------------------------------------------------

Friday, October 6, 2017

Breakfast events for registered GSCM Conference guests (in W410 TNRB)	
7:30 a.m.	Registration (desk outside of W410 TNRB).
8:00 a.m.	Welcome by Associate Dean Michael Thompson. Prayer. Buffet breakfast.
8:30 a.m.	Building our program and building our GSCM Alumni Network.
9:00 a.m.	Keynote Speaker: Chad Lewis, NFL Super Bowl player and BYU Associate Athletic Director. Talk title: "Surround Yourself with Greatness."
9:30 a.m.	Review of conference schedule.

Breakout sessions for current students and registered GSCM Conference guests				
TRACK:	Info Technology in GSCM	GSCM Best Practices	Special Topics in GSCM	GSCM Career Fair
Room:	W308 TNRB	W310 TNRB	W208 TNRB	1st Floor Atrium
10:00 a.m. to 10:45 a.m.	Cyber Security within the Supply Chain Paul Levine, Executive Director, National Motor Freight Traffic Association (NMFTA)	From Cadillac to Mickey Mouse to Facebook – Hints and Tips from a Supply Chain Journey Derek Johnson, Global Process Owner - Strategic Sourcing, Facebook	Is a GSCM MBA for me? Professors Tom Foster and Dan Snow, BYU Marriott School	GSCM Career Fair for Undergraduate GSCM Students
11:00 a.m. to 11:45 a.m.	Cyber Security within the Supply Chain (repeat session) Paul Levine, Executive Director, National Motor Freight Traffic Association (NMFTA)	General Motors Purchasing, Supply Chain and Logistics: Individually Very Strong; Collectively Focused to Win Marc Menden, VP Global Purchasing and Supply Chain, General Motors South America	A Modern Scriptural Supply Chain Professor Jack Welch, BYU Law School, founder of FARMS (Mormon Studies)	

- continued on other side -

Friday, October 6, 2017 - continued (keynote talk moved to 3:30pm)

noon to 1:15 p.m. Networking lunch for registered GSCM Conference guests at the 1st floor Blue Line Deli area. Registered guests can pick up box lunches at northwest corner of Blue Line (see map below).

Breakout sessions for current students and registered GSCM Conference guests				
TRACK:	Info Technology in GSCM	GSCM Best Practices	Special Topics in GSCM	GSCM Career Fair
Room:	W308 TNRB	W310 TNRB	W208 TNRB	1st Floor Atrium
1:30 p.m. to 2:15 p.m.	Big Data Analytics – Make Data Your Most Powerful Resource Becky Tasker, Adobe Digital Insights	Supplying the hands that deliver care – How Intermountain Healthcare's Supply Chain Organization is connected to the delivery of care Kreg Koford, AVP, Strategic Solutions and Sourcing, Intermountain Healthcare	Women in Supply Chain: Is a BYU MBA for me? Professors Cindy Wallin, Tom Foster, Dan Snow, BYU Marriott School	GSCM Career Fair for current BYU MBA GSCM Students
2:30 p.m. to 3:15 p.m.	Machine Learning and Artificial Intelligence Ben Taylor, Chief Data Officer, Ziff.ai	LDS Church GSCM – In the Service of All Mankind Paul Hansen, Director Asia Area Presiding Bishopric Office. Bruce Muir, Director of Emergency Response Division.	Understanding International Business Culture – Are you Literate? Professor Simon Greathead, BYU Marriott School	

3:30 p.m. to 4:30 p.m. **Keynote Speaker: Presiding Bishop Gérald Caussé, former Director of Logistics for Carrefour and General Manager of Pomona, speaking on "Doing Good through Global Supply Chain Management." 151 TNRB.**

4:30 p.m. Brief opportunity for interested students/alumni to meet with Bishop Caussé.

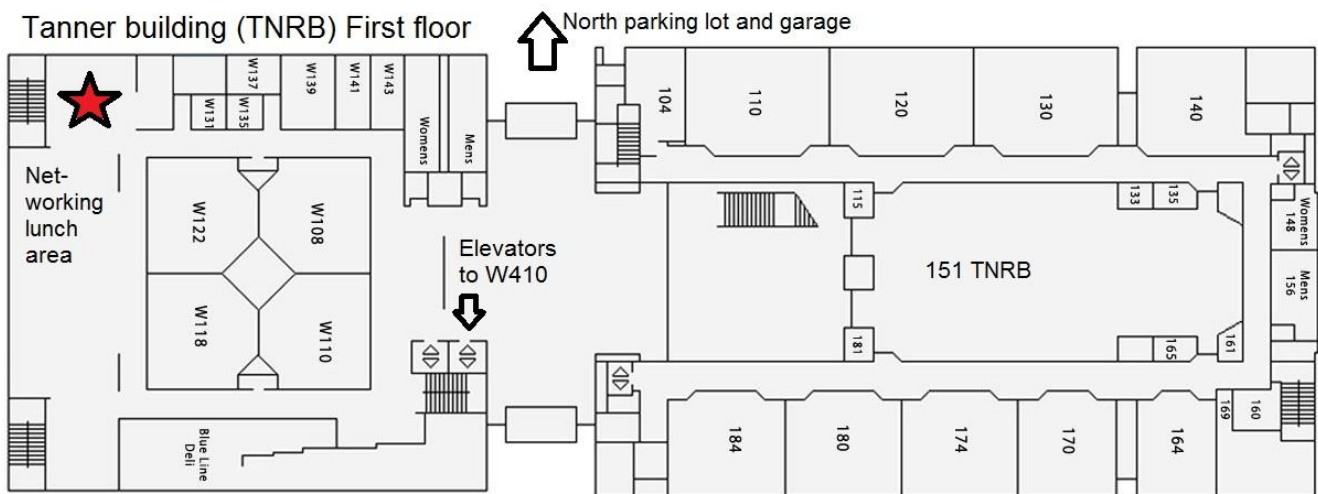

Stay connected! Bookmark <http://supplychain.byu.edu>